



# ANJALY SUPREMUS

Dreams turned into Reality...



**Price List &  
Payment Schedule**

HOWRAH BRIDGE

NANDARAM MARKET

FAIRLY PLACE

22 N.S. ROAD

RBI KOLKATA

GILLANDER HOUSE

ANDREW'S CHURCH

LAL DIGHI

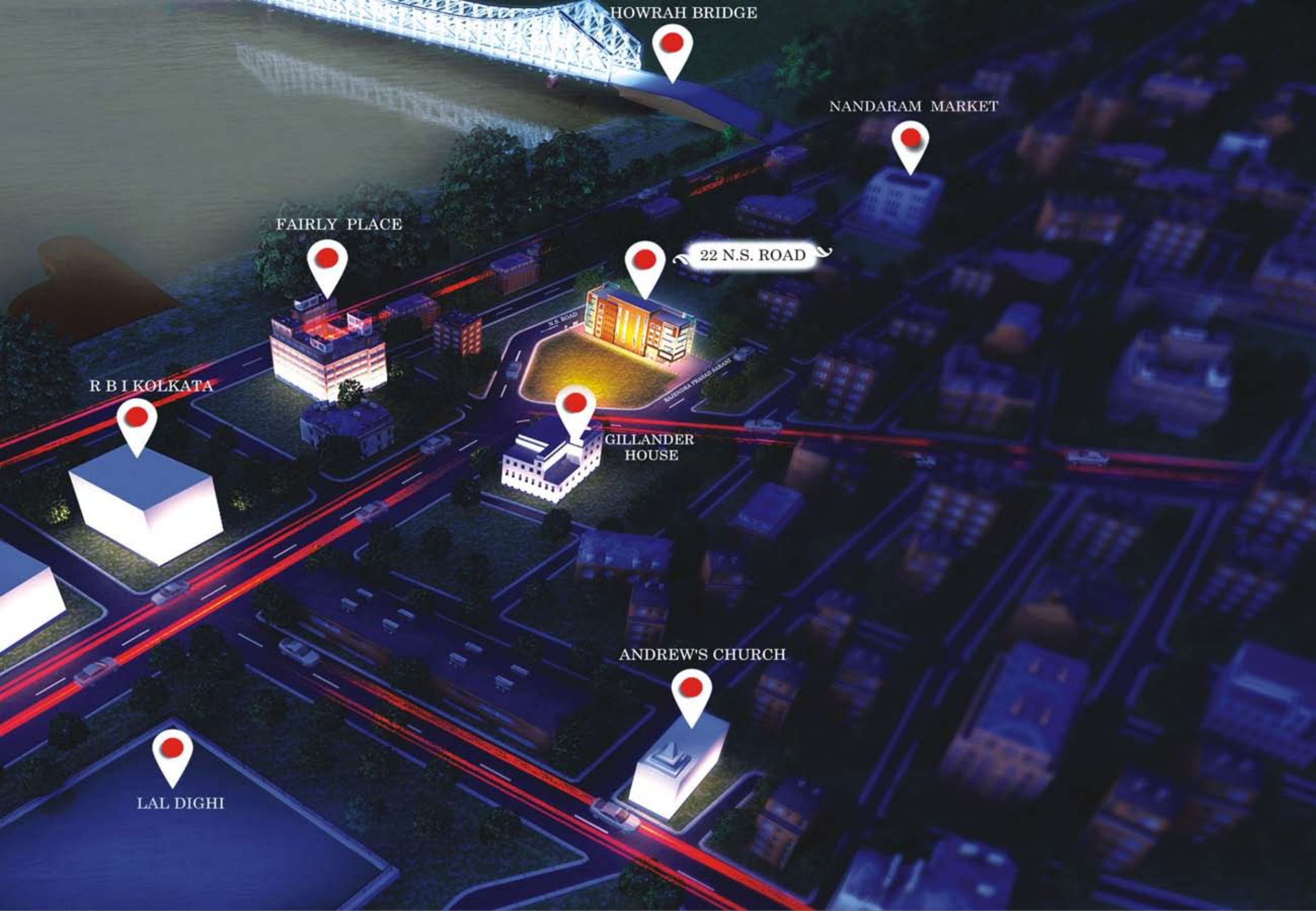



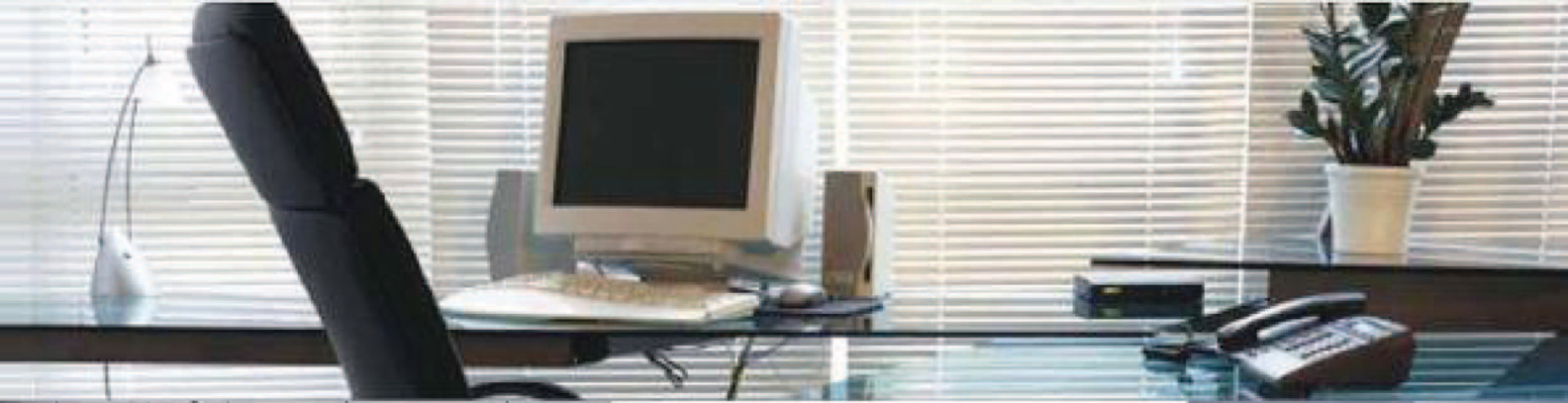



# ANJALY SUPREMUS

Dreams turned into Reality...



GROUND FLOOR PLAN



# ANJALY SUPREMUS

Dreams turned into Reality...

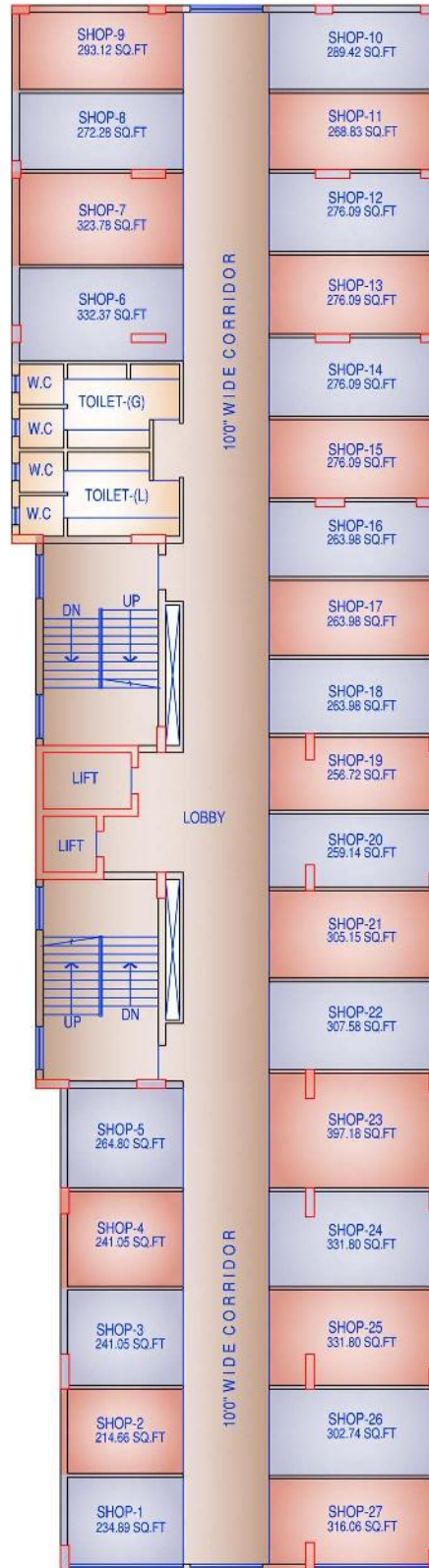

FIRST FLOOR PLAN



# ANJALY SUPREMUS

Dreams turned into Reality...

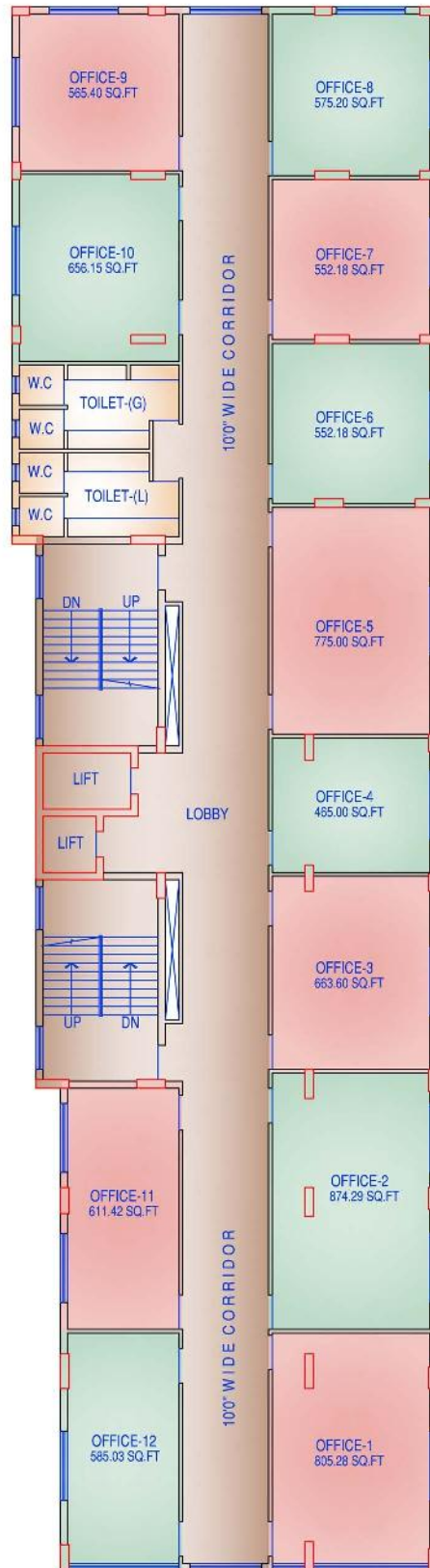

TYPICAL FLOOR PLAN (2ND TO 5TH)



**ANJALY SUPREMUS**  
Dreams turned into Reality...

### **RATE CHART**

<b>Floor</b>	<b>Rate</b>	<b>Units</b>	
Ground Floor	NA	NA	Shops
First Floor	Rs 35,000/-	3	Shops
Second Floor	Rs 30,000/-	4	Office
Third Floor	Rs 28,000/-	6	Customized Office Layout
Fourth Floor	Rs 28,000/-	6	Customized Office Layout
Fifth Floor	Rs 28,000/-	12	Customized Office Layout
Parking on Pay as Use Basis / Monthly Rental			
GST – 12% to be added			

The project is expected to be completed by December 2024. Here are some features of the Building.

- Rooftop Banquet and Conference Room.
- Open Air Sitting Area with Food Stalls.
- Pavement Walk Way & Roof Pavement.
- Outside Glass and Marble Facade. Energy efficient glazing and roof insulation.
- Multilevel Parking for 55 Nos. Car for Owners and Guest.
- 2 Elevators with 15 PAX each and Goods Elevator from Basement.
- Separate Transformer, Automatic Generators/ UPS equipped for Uninterrupted Power and Voltage Supply.
- Fire Fighting Equipment's as per NBC and WBFES compliance.
- Surveillance Equipment's / Close Circuit Cameras.
- WIFI Building.
- Green Building Compliance, Earthquake Resistance and STAAD analysis for seismic and wind parameters incorporated in structural design.
- Energy Efficiency of glazing to maximize natural light and minimize heat load.



**ANJALY SUPREMUS**  
Dreams turned into Reality...

<b>PAYMENT SCHEDULE (PHASE 2)</b>	
<b>ON BOOKING</b>	Rs 22,22,001/-
ON 21 Days from Booking	20% (Less the Booking amount)
ON 60 Days from Date of Booking	20% (Less the Booking amount)
ON <b>SIGNING</b> of Agreement of Sale	25%
On <b>POSSESSION</b>	25%
On <b>REGISTRATION</b> / Signing of Deed Of Sale whichever is earlier.	10%
PARKING:- Pay per Use or Monthly Rental Basis against Deposit	
<b>** EXTRA COST (ON OR BEFORE POSSESSION)</b>	
Legal Charges	Rs. 25,000/-
Municipal Charges	as actual
Maintenance Charges (To be increased every 4 years on 20% of the Present Maintenance Charge)	Rs 8/- per Sq.ft
Electricity Deposit	Rs 10,000/- per KVA
Generator Charges	Rs 100/ per Sq.ft
<b>OTHER DETAILS</b>	
Cancellation Charges	10% of the total Consideration Value.
Agreement Of Sale	On Payment of 40%
GST	12%
<b>SHIFTING OF OFFICE AND SHOP IS NOT ALLOWED</b>	
Note: all the above details are subjected to revision without any prior information.	

